

THREE FINGER CLIPS (METRIC)

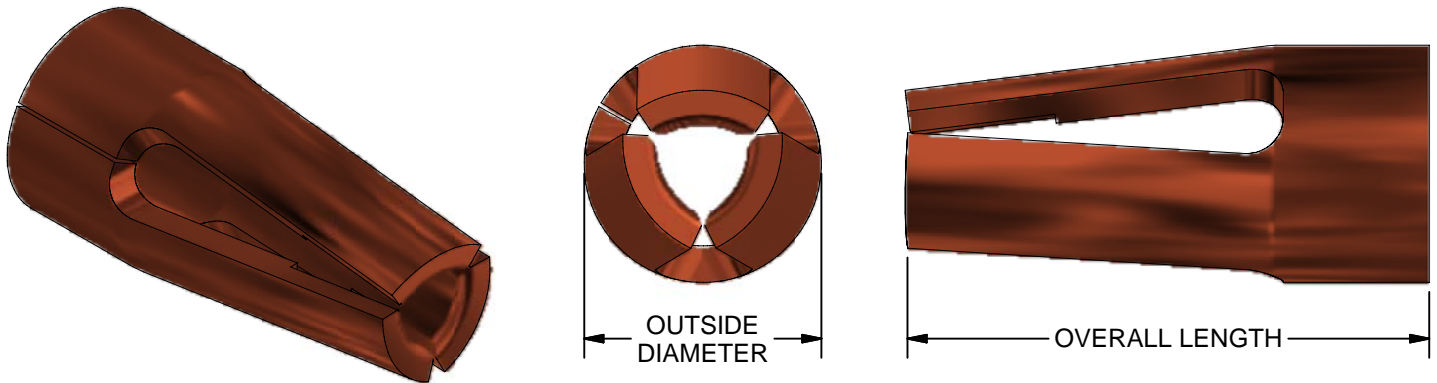

| PART NUMBER | OUTSIDE DIAMETER | OVERALL LENGTH | OPERATING RANGE PIN DIA. | TEST PIN DIAMETER | MAXIMUM INSERTION FORCE | MINIMUM WITHDRAWAL FORCE |
|-------------|------------------|----------------|--------------------------|-------------------|-------------------------|--------------------------|
| DT-1* | .787 | 1.905 | .381 - .508 | .432 | 80 GM | 15 GM |
| DT-1L* | .787 | 1.905 | .381 - .533 | .457 | 90 GM | 14 GM |
| DT-2 | .813 | 1.270 | .381 - .457 | .432 | 400 GM | 100 GM |
| DT-3 | .787 | 1.905 | .381 - .508 | .432 | 42 GM | 14 GM |
| DT-3X | .787 | 1.905 | .381 - .533 | .457 | 30 GM | 10 GM |
| DT-4 | .5969 | 1.651 | .178 - .330 | .279 | 30 GM | 9 GM |
| DT-5 | .4978 | 1.346 | .152 - .279 | .203 | 30 GM | 10 GM |

* - SIZING PIN DIAMETER IS .533.

NOTE: ALL CLIPS PRODUCED FROM BeCu ALLOY 172 1/2 HD AND HEAT TREATED AFTER FORMING.

ALL SPECIFICATIONS REFER TO CLIPS THAT ARE NOT PLATED.

THE ABOVE INFORMATION IS PROVIDED FOR REFERENCE ONLY. ENGINEERING DRAWINGS CAN BE PROVIDED.

ditron inc.

81 SOUTH GREENHAVEN ROAD, PO BOX 375, STORMVILLE, NEW YORK 12582

TELEPHONE: (845) 227-9300

FAX: (845) 227-2872

WWW.DITRONINC.COM